

QUICK COUPLER

Series WQ

Cat No WQ - 01 - 01

QUICK COUPLER - 5NW, 8NW

Features

- Nickel plated brass body
- High flow characteristics
- Wide range of models
- Maintenance free and long life
- Compact size
- Attractive design
- Teflon pre-coated male taper threads



Application

This can be effectively used in all compressed air line applications
Some of them include

- All compressed air lines
- Assembly lines with pneumatic tools / Machinery with pneumatic systems
- Pneumatic control panels

Operation

To connect the coupling, simply push the plug in to the coupling.

To disconnect the coupling, push the sleeve back and the plug automatically comes out.

Safety precautionary note

During disconnecting under pressure, the plug comes out with high speed and force. Hence care to be taken to prevent injury.

Technical Specifications

| Model No | Socket | WQC03... | WQC14... |
|-------------------------------|--------|--|----------|
| | Plug | WQP03... | WQP14... |
| NW | | 5 | 8 |
| Thread | | 1/4 | 1/2 |
| Medium | | Air | |
| Working Pressure range | | 0 - 10 bar | |
| Ambient / Medium temperature | | 5° - 60° C | |
| Flow (lpm) | | 1000 | 2250 |
| Coupling load at 10 bar (kgf) | | 13 | 15 |
| Materials of construction | | Brass, Stainless steel, Nitrile & Acetal | |

QUICK COUPLER

Series WQ

Cat No WQ - 01 - 01

MODEL WQC03 (NW - Ø5)

Socket

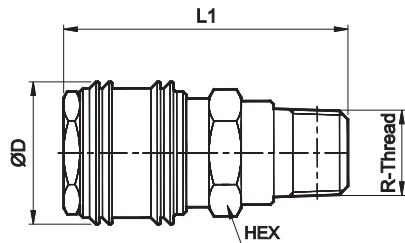

| Thread | ØD | L1 | HEX | Ordering No |
|--------|----|----|-----|-------------|
| R1/4 | 22 | 44 | 17 | WQC03M51 |

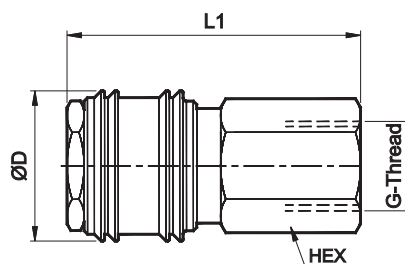

| Thread | ØD | L1 | HEX | Ordering No |
|--------|----|----|-----|-------------|
| G1/4 | 22 | 43 | 17 | WQC03F61 |

MODEL WQP03

Plug

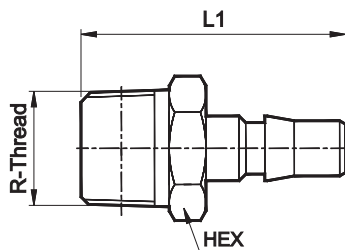

| Thread | ØD | L1 | HEX | Ordering No |
|--------|----|------|-----|-------------|
| R1/4 | - | 36.5 | 14 | WQP03M51 |

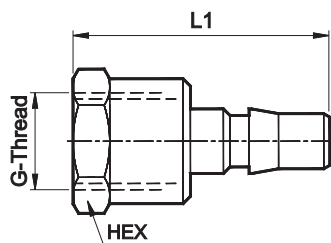

| Thread | ØD | L1 | HEX | Ordering No |
|--------|----|----|-----|-------------|
| G1/4 | - | 35 | 17 | WQP03F61 |

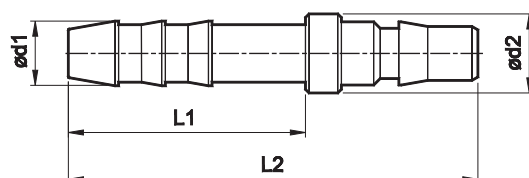

| Applicable Hose ID | Ød1 | Ød2 | L1 | L2 | Ordering No |
|--------------------|-----|-----|----|----|-------------|
| Ø8 | 9 | 11 | 33 | 57 | WQP03T08 |

QUICK COUPLER

Series WQ

Cat No WQ - 01 - 01

MODEL WQC14 (NW - Ø8)

Socket

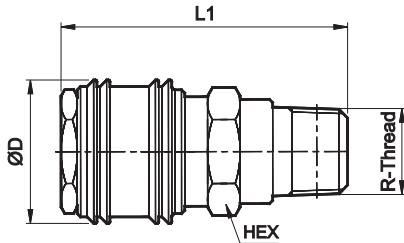

| Thread | ØD | L1 | HEX | Ordering No |
|--------|------|------|-----|-------------|
| R1/2 | 27.5 | 48.5 | 22 | WQC14M53 |

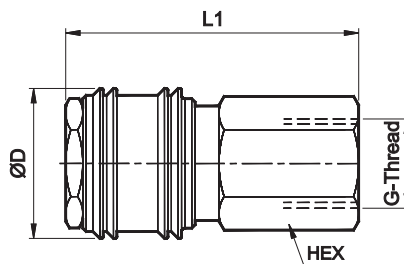

| Thread | ØD | L1 | HEX | Ordering No |
|--------|------|----|-----|-------------|
| G1/2 | 27.5 | 57 | 24 | WQC14F63 |

MODEL WQP14

Plug

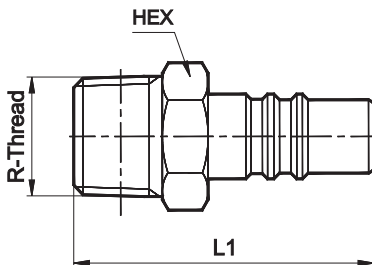

| Thread | ØD | L1 | HEX | Ordering No |
|--------|----|----|-----|-------------|
| R1/2 | - | 48 | 22 | WQP14M53 |

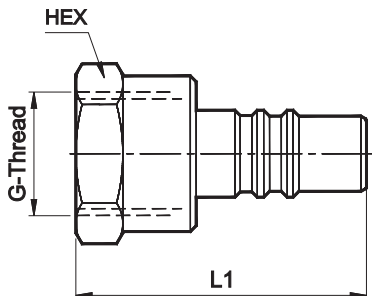

| Thread | ØD | L1 | HEX | Ordering No |
|--------|----|----|-----|-------------|
| G1/2 | - | 45 | 27 | WQP14F63 |

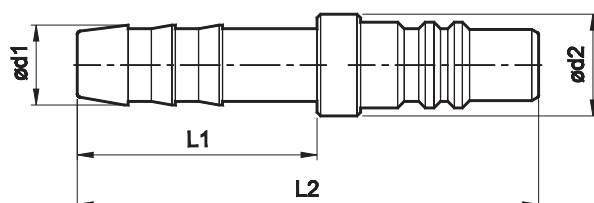

| Applicable Hose ID | Ød1 | Ød2 | L1 | L2 | Ordering No |
|--------------------|-----|-----|----|------|-------------|
| Ø10 | 11 | 14 | 33 | 63.5 | WQP14T10 |

Subject to change